

LITTLE CAYMAN LAND 2.5 ACRES - BY AIRPORT (MLS#: 420929)

DETAILS

Price: CI\$180,000

MLS#: 420929

Type: Land

Status: Active

Block: 80A

Parcel: 33

Width: 70.00

Depth: 1,000.00

Acres: 2.50

DESCRIPTION

Development opportunity in the stunning island of Little Cayman. This length of land really consists of two parcels separated by a planned future roadway, offering flexibility for a variety of residential, commercial, or investment possibilities. Located beside the airport, the first parcel measures approximately 800 feet in length, with a width ranging from 72 to 80 feet. The second parcel extends approximately 240 feet in length, with a width expanding from 36 to 62 feet. Combined, the parcels offer approximately 78,880 square feet of land. Whether you're seeking to develop, invest, or secure a landholding in one of the Caribbean's most beautiful and tranquil islands, this property presents potential. Contact Agent for more information.

FEATURES

Zoning: Low Density residential

IMAGES

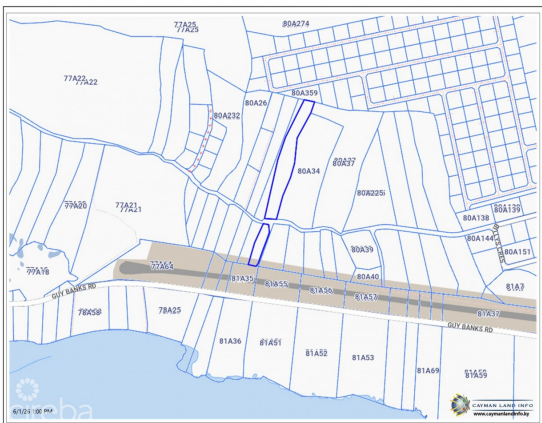



CIREBA MLS LDX feed courtesy of CENTURY 21 THOMPSON REALTY

***Disclaimer:** The information contained herein has been furnished by the owner(s) and or their nominee and represented by them to be accurate. The listing company, agent and CIREBA MLS disclaims any liability or responsibility for any inaccuracies, errors or omissions in the represented information. The listing details herein are also courtesy of CIREBA (Cayman Islands Real Estate Brokers Association) MLS and/or via LDX (Listing Data Exchange) feed. All the information contained herein is subject to errors, omissions, price changes, prior sale or withdrawal, without notice and is at all times subject to verification by the purchaser(s).