LARGE OCEAN VIEW PARCELS- 3 IN 1 (MLS#: 420687)

DETAILS

Price: CI\$575,000	MLS#: 420687	Type: Land	Status: Active
Block: 75A	Parcel: 309,310,311		
Width: 300.00	Depth: 100.00		
Acres: 0.87			

DESCRIPTION

Tucked just beyond the iconic East End Lighthouse, these three adjoining parcels present a rare opportunity to secure a prime position within one of the district's most thoughtfully planned and up-and-coming communities. With paved roads, quality infrastructure, and generously sized lots throughout, this subdivision is already setting the tone for a well-established and desirable neighborhood. Each parcel spans approximately one-third of an acre, offering ample space to design and build a substantial home while still enjoying privacy and open surroundings. Notably, these are among the highest elevation lots in the area- sitting between 20-24 feet above sea level- providing a true "high and dry" setting, which is a significant advantage for coastal living in Cayman. Just steps away, you'll find a beautiful stretch of sandy beachfront with stunning ocean views, giving you the best of both worlds: elevated positioning with easy access to the water. East End continues to grow in popularity for those seeking a quieter, more relaxed lifestyle, and this particular pocket stands out for its setting, infrastructure, and overall appeal. It offers a balance of tranquility and value, making it an excellent option for both end users and investors looking to secure land in an area with strong future potential. The ownercomplete details on website.

FEATURES

Zoning: Medium Density Residential

IMAGES

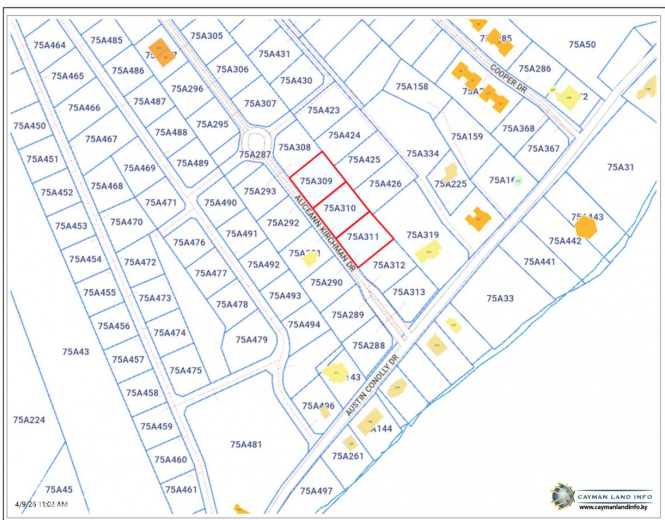



CIREBA MLS LDX feed courtesy of KELLER WILLIAMS

***Disclaimer:** The information contained herein has been furnished by the owner(s) and or their nominee and represented by them to be accurate. The listing company, agent and CIREBA MLS disclaims any liability or responsibility for any inaccuracies, errors or omissions in the represented information. The listing details herein are also courtesy of CIREBA (Cayman Islands Real Estate Brokers Association) MLS and/or via LDX (Listing Data Exchange) feed. All the information contained herein is subject to errors, omissions, price changes, prior sale or withdrawal, without notice and is at all times subject to verification by the purchaser(s).