

## BEACHFRONT LAND ON NORTH COAST EAST ROAD (MLS#: 420509)

### DETAILS

Price: US\$250,000  
Block: 91A  
Width: 120.00  
Acres: 0.51

MLS#: 420509  
Parcel: 138  
Depth: 160.00

Type: Land

Status: Active

### DESCRIPTION

A large, well-shaped residential parcel with magnificent beach and ocean views to the north, perfect to build that get-away home

### FEATURES

### IMAGES

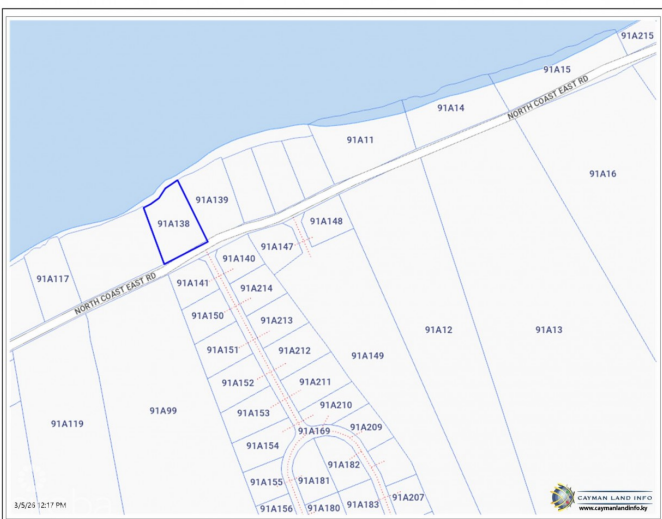
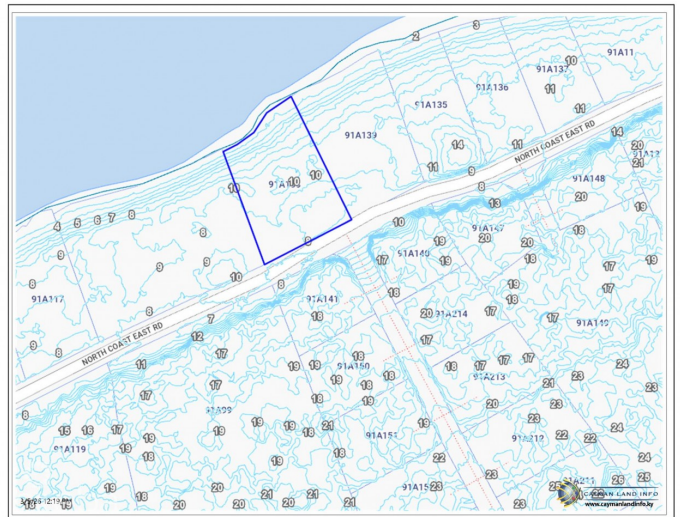



---

CIREBA MLS LDX feed courtesy of CAYMAN ISLANDS PROPERTIES

**\*Disclaimer:** The information contained herein has been furnished by the owner(s) and or their nominee and represented by them to be accurate. The listing company, agent and CIREBA MLS disclaims any liability or responsibility for any inaccuracies, errors or omissions in the represented information. The listing details herein are also courtesy of CIREBA (Cayman Islands Real Estate Brokers Association) MLS and/or via LDX (Listing Data Exchange) feed. All the information contained herein is subject to errors, omissions, price changes, prior sale or withdrawal, without notice and is at all times subject to verification by the purchaser(s).