

## TROPICANA CRESCENT LAND (MLS#: 420385)

### DETAILS

Price: CI\$2,190,000

MLS#: 420385

Type: Land

Status: Active

Block: 20D

Parcel: 102/103

Width: 776.00

Depth: 202.00

Acres: 2.74

### DESCRIPTION

Ideal location for small residential Development on outskirts of George Town. Land has good elevation between 5 to 8 feet, needs clearing and designated access Road needs to be constructed but the site offers tremendous opportunity for development or as land Bank. Motivated sellers so bring all offers.

### FEATURES

Zoning: Medium Density Residential

### IMAGES

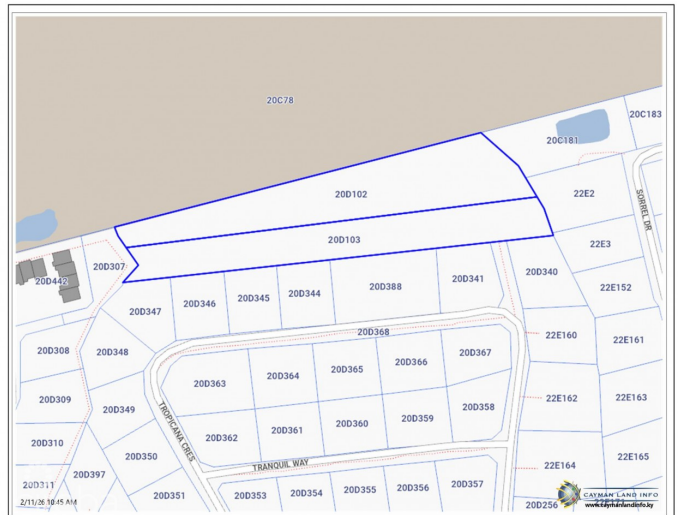

### MAP



---

CIREBA MLS LDX feed courtesy of ERA CAYMAN ISLANDS

**\*Disclaimer:** The information contained herein has been furnished by the owner(s) and or their nominee and represented by them to be accurate. The listing company, agent and CIREBA MLS disclaims any liability or responsibility for any inaccuracies, errors or omissions in the represented information. The listing details herein are also courtesy of CIREBA (Cayman Islands Real Estate Brokers Association) MLS and/or via LDX (Listing Data Exchange) feed. All the information contained herein is subject to errors, omissions, price changes, prior sale or withdrawal, without notice and is at all times subject to verification by the purchaser(s).