

---

## RED BAY ABBEY WAY CANAL FRONT HOUSE LOT (MLS#: 419819)

### DETAILS

---

Price: CI\$440,000	MLS#: 419819	Type: Land	Status: Active
Block: 22D	Parcel: 257		
Width: 99.00	Depth: 190.00		
Acres: 0.44			

### DESCRIPTION

---

This 0.44-acre canal front parcel on Abbey Way in Red Bay is the perfect setting to build the life you've been dreaming of. In a quiet, established neighborhood just minutes from George Town, it blends everyday convenience with the luxury of waterfront living. Living canal front means more than a view—it's a lifestyle. Step from your backyard to your private dock, with the North Sound at your doorstep. Spend mornings cruising to Stingray City, afternoons fishing or paddleboarding, and evenings surrounded by the calm of the water. With room for a spacious residence, pool, and outdoor entertaining, this property offers the chance to create a home that flows seamlessly between land, sea, and sky. Abbey Way sets the stage, but it's the waterfront lifestyle that makes it unforgettable.

### FEATURES

---

Zoning: Low Density residential

# IMAGES

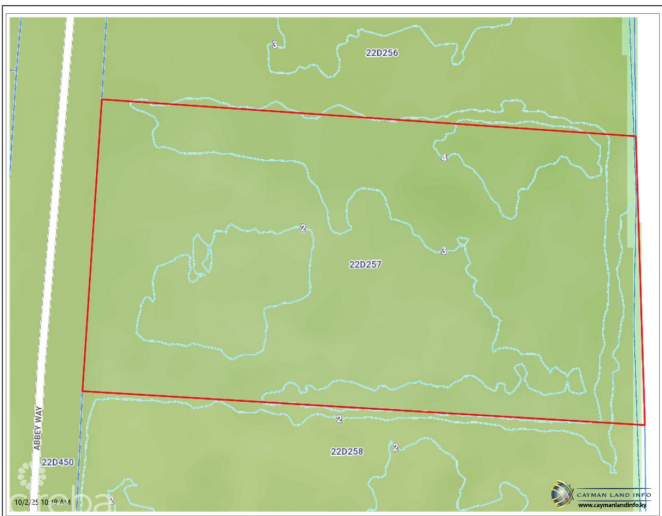



---

CIREBA MLS LDX feed courtesy of BERKSHIRE HATHAWAY HOMESERVICES CAYMAN ISLANDS

**\*Disclaimer:** The information contained herein has been furnished by the owner(s) and or their nominee and represented by them to be accurate. The listing company, agent and CIREBA MLS disclaims any liability or responsibility for any inaccuracies, errors or omissions in the represented information. The listing details herein are also courtesy of CIREBA (Cayman Islands Real Estate Brokers Association) MLS and/or via LDX (Listing Data Exchange) feed. All the information contained herein is subject to errors, omissions, price changes, prior sale or withdrawal, without notice and is at all times subject to verification by the purchaser(s).